

**PARTS**

(1) Hardware

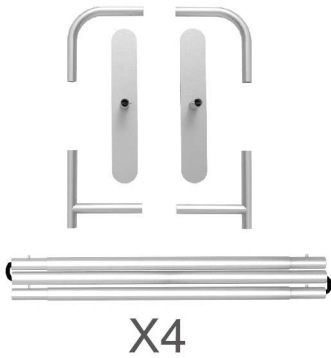

(2) Graphic printing fabric banner

**STEP 01**

To connect the poles according to the labellings

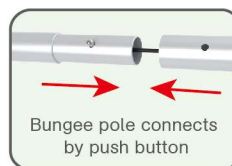
**STEP 02**

To use corner pieces to connect the poles to be display stand

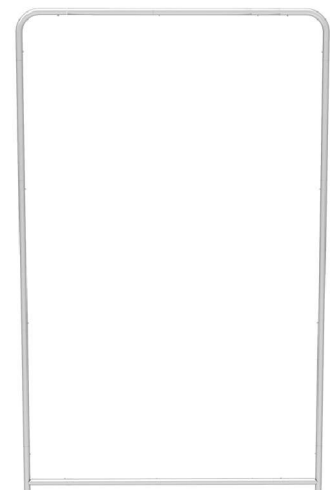
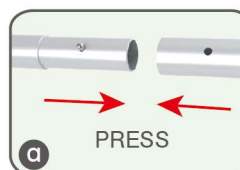
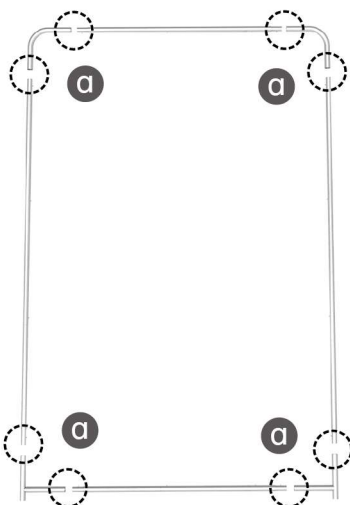

**PARTS****STEP 03**

To slide the fabric banner on the frame from top and zip up at bottom

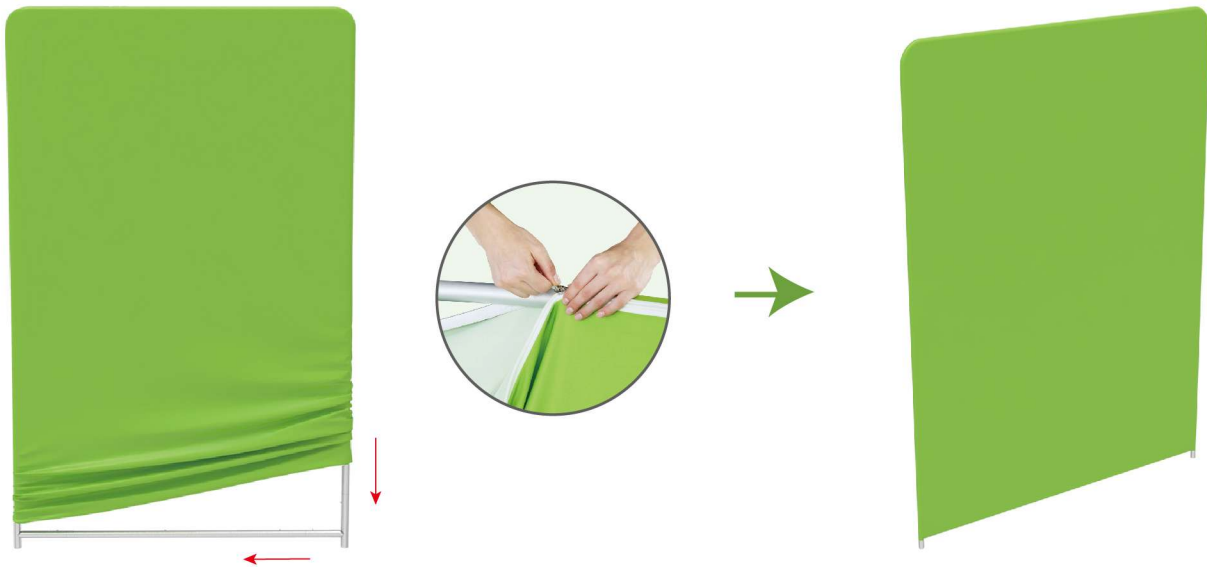
**STEP 04**

To assemble the stand feet in position

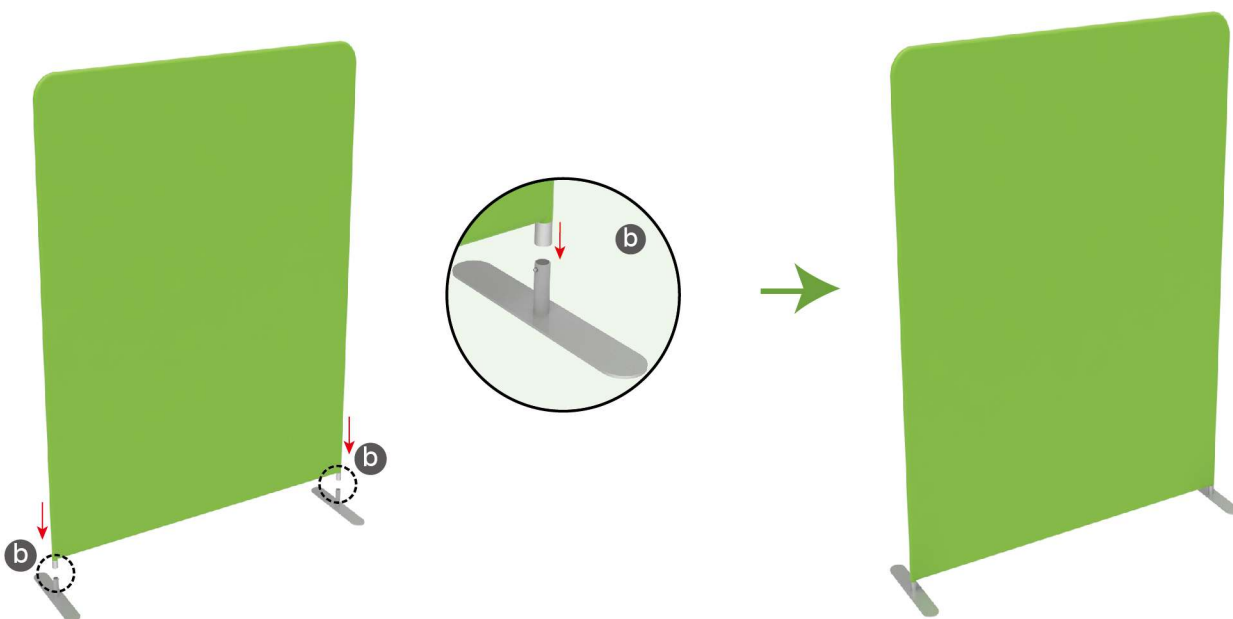

## PARTS

(1) Hardware

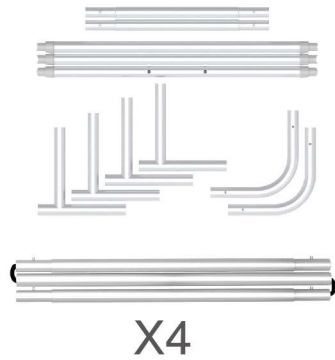

(2) Graphic printing fabric banner



## STEP 01

To connect the poles according to the labellings

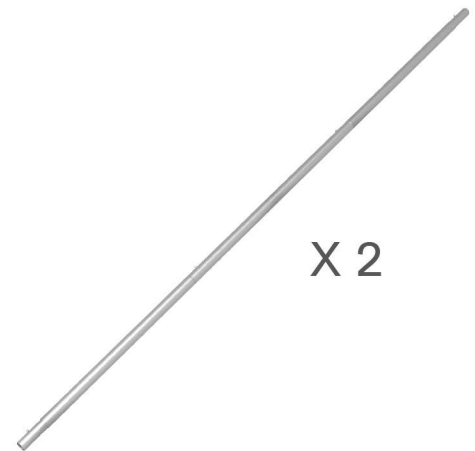
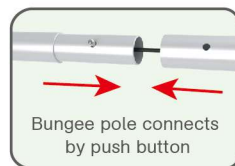
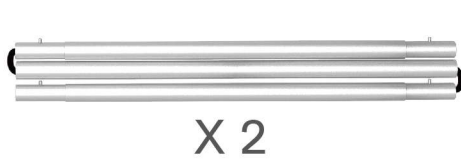

## STEP 02

To use corner pieces to connect the poles to be display stand

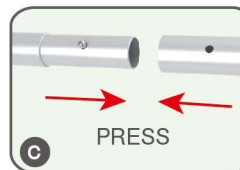
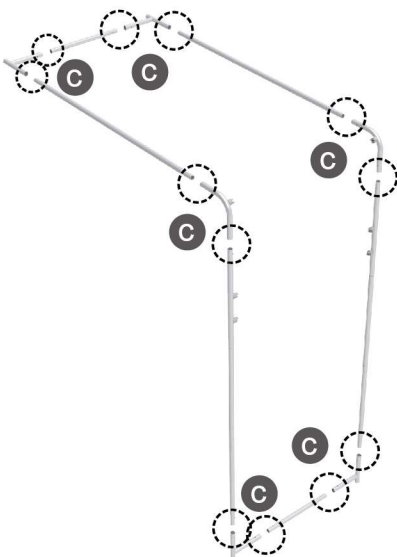

## PARTS

## STEP 03

To install the cross bar according to the labellings

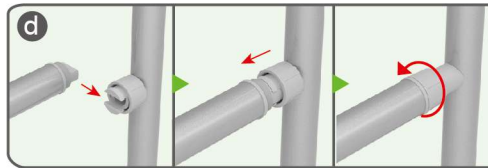
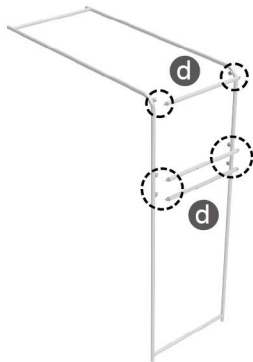

## STEP 04

To Wrap the fabric banner from side to sides and zip up



## STEP 05

To assemble the feet in position

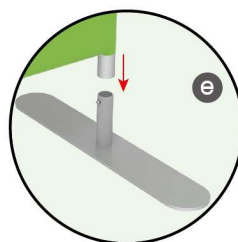
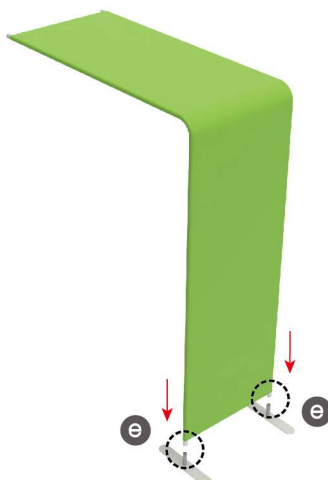

**PARTS**

(1) Hardware

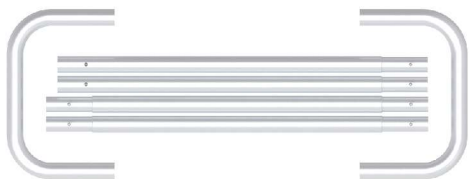

(2) Graphic printing fabric banner

**STEP 01**

To connect the poles according to the labellings

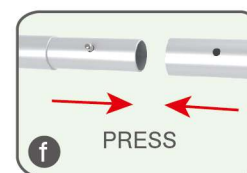
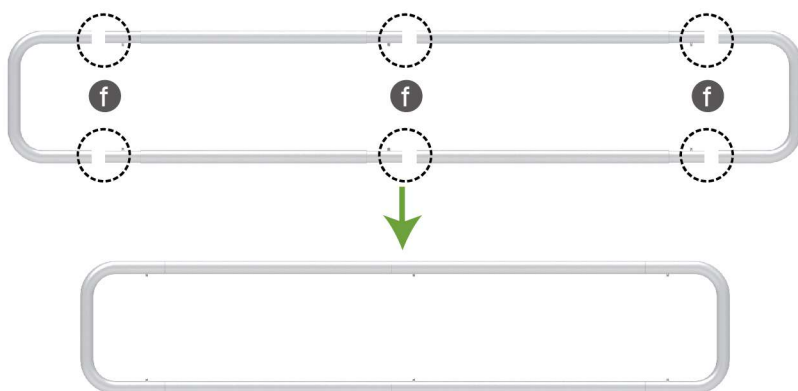
**STEP 02**

To wrap up the fabric banner from side to side and zip up

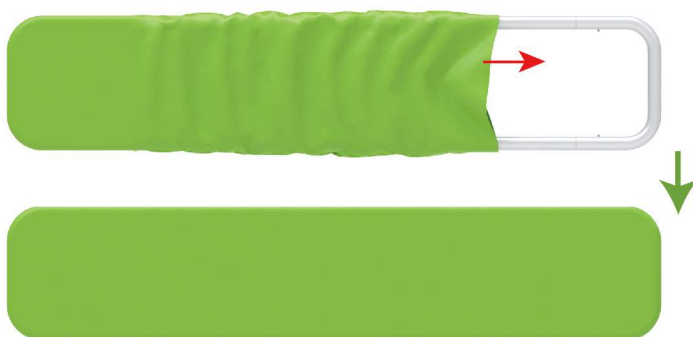

Same steps for below style of headers

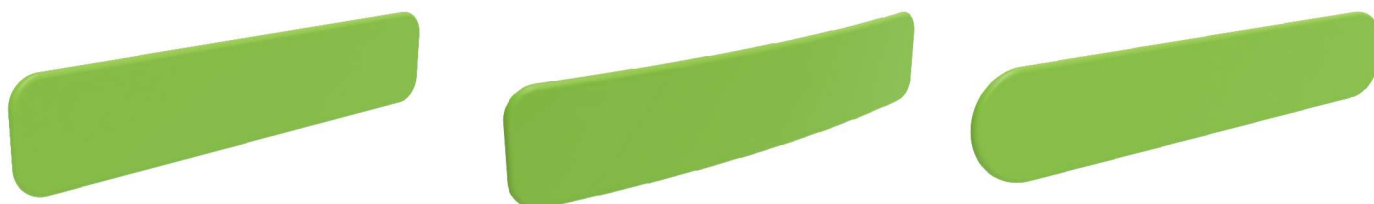

## PARTS

## (1) Booth Set



X2



X2

## STEP 01

To attach the Arch TV stand to the backwall and fasten the clamp by Allen key

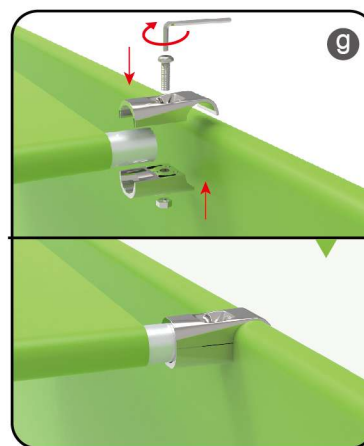

## PARTS

## STEP 02

To use C clip & Allen Key to fasten the header on the backwall

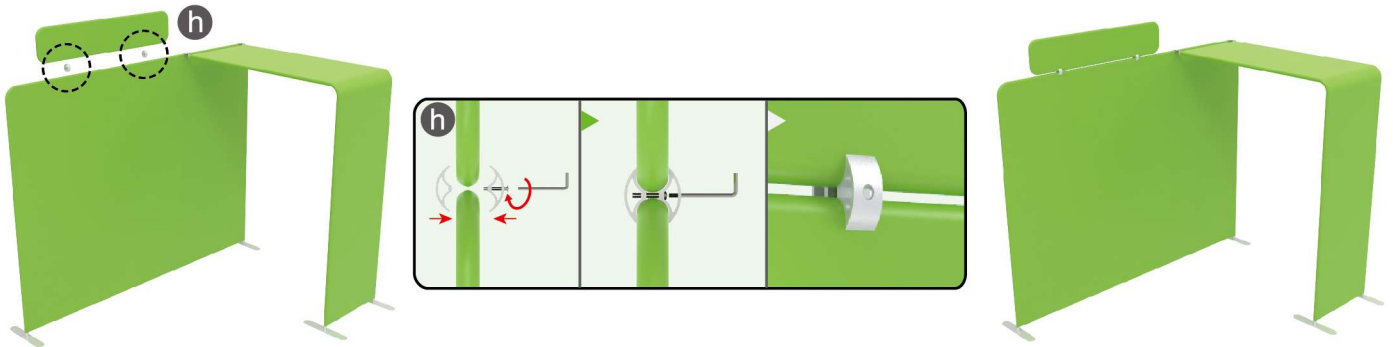

## STEP 04

To install the TV mount in position

